

DUCK CREEK DRIVE

DUCK CREEK DRIVE CULVERT HEADWALL, GABIONS, AND GRADING AROUND HEADWALL

REMOVE EXISTING HEADWALL

CONSTRUCT 37 SY
12" GABION MATTRESS
PER DETAIL SHEET PP-14

DUCK CREEK GREENBELT POND
NORMAL POOL VOLUME = 11.34 AC-FT
BOTTOM ELEV. = 469.50
PROP NORMAL POOL ELEV. = 478.00

CONSTRUCT 220 CY
GABIONS AROUND
PERIMETER OF
SPILLWAY PER DT-4

1740 CY FILL AND
2140 SY SODDING

REMOVE EXISTING TREES AND
VEGETATION, AND TIE INTO
EXISTING GROUND SURFACE
WITH PROPOSED FILL

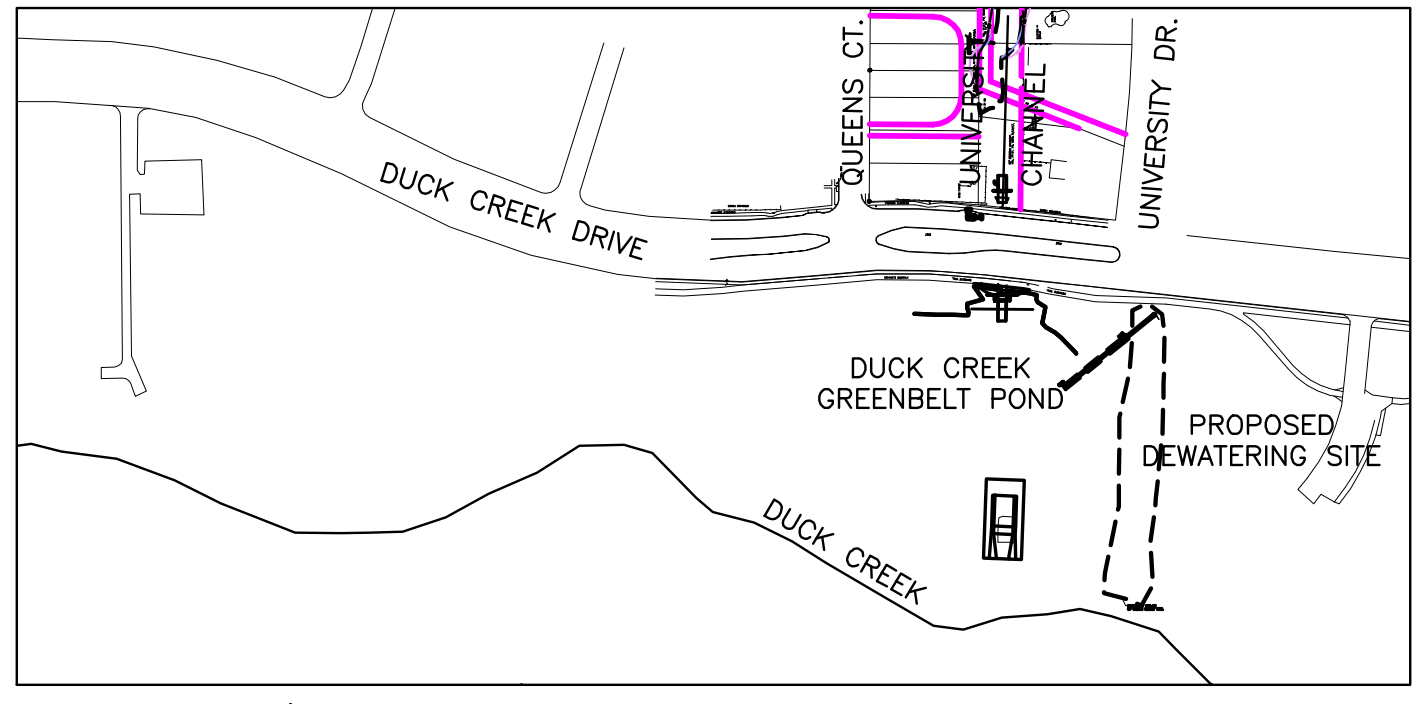

POND LOCATION
1"=250'

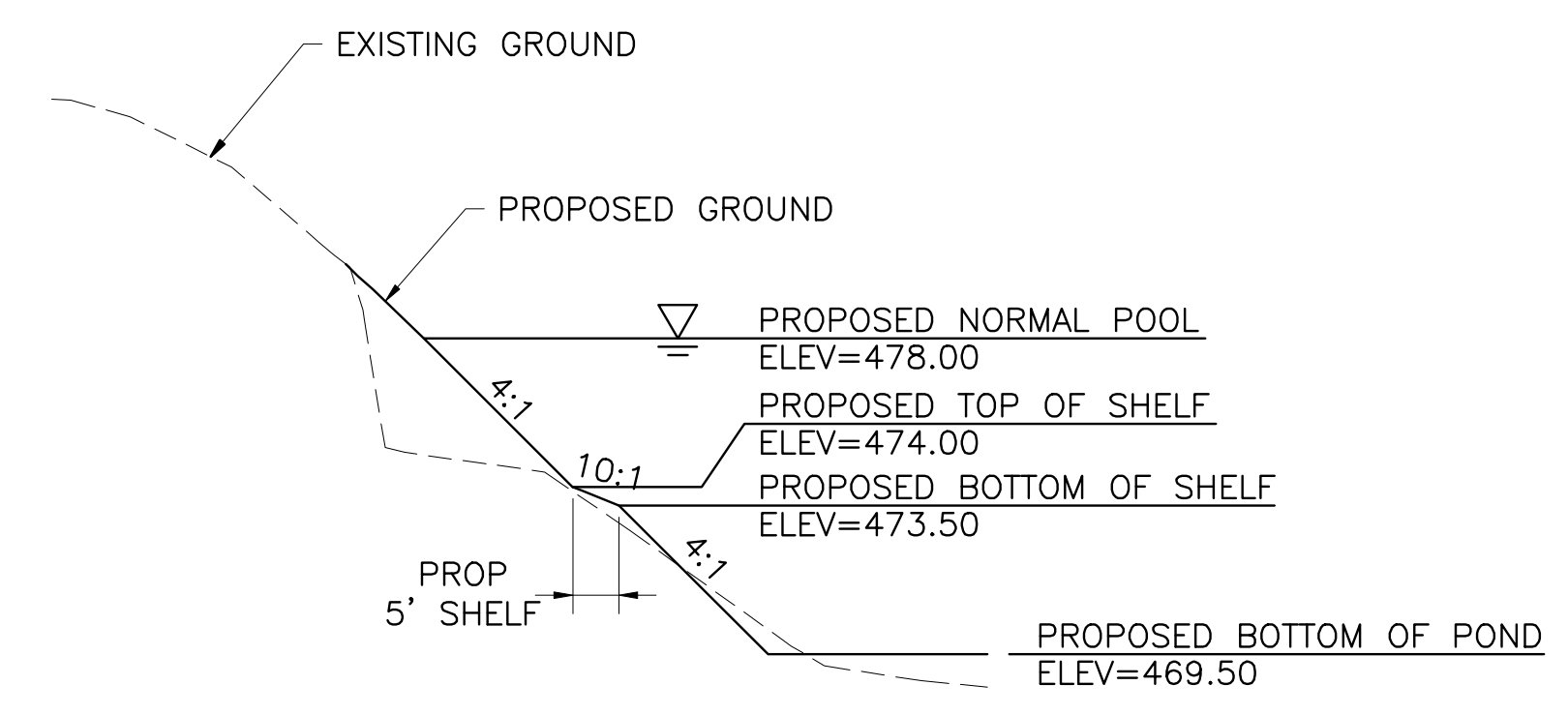

BANK SECTION
NOT TO SCALE

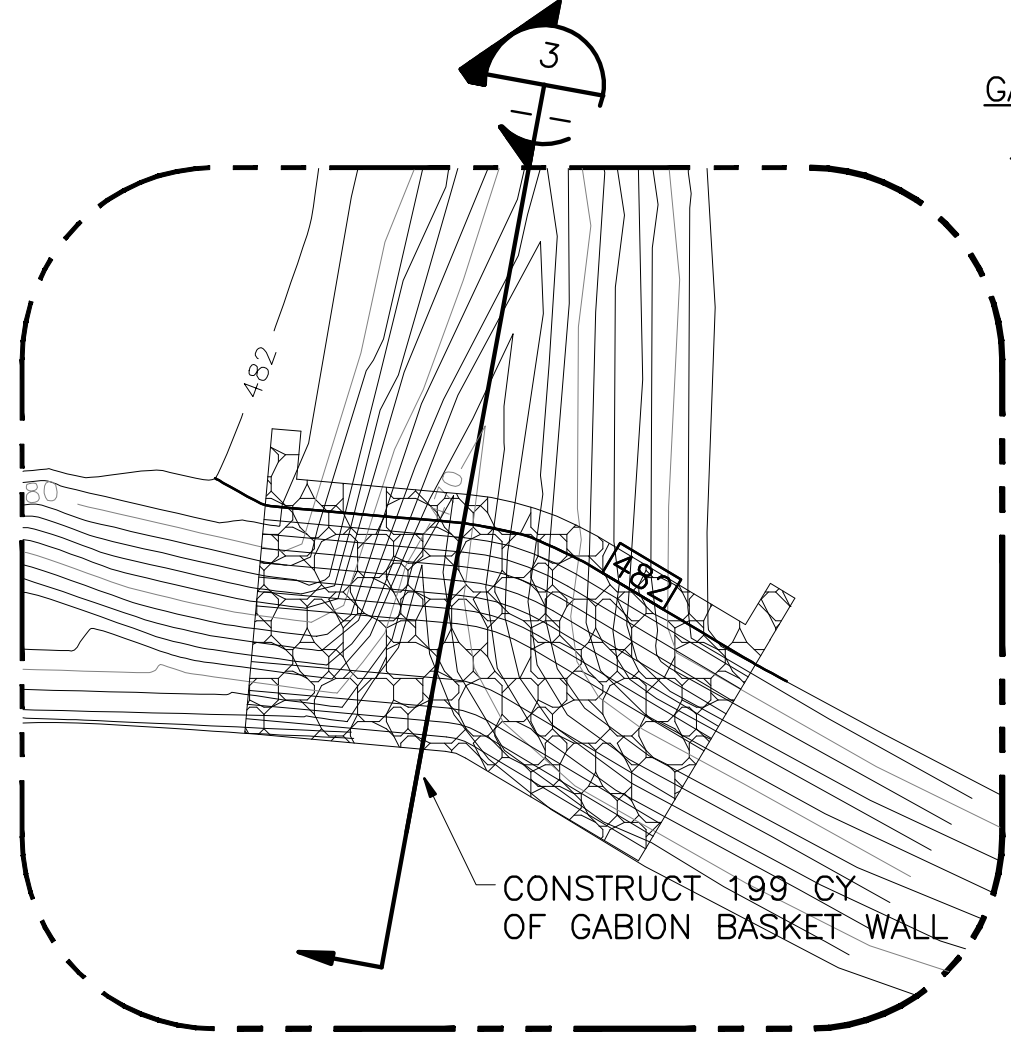

FILL AREA BLOW-UP
1"=20'

GABION WALL NOTES:

- FOR RETAINING WALL SYSTEM, CONTRACTOR SHALL PROVIDE SHOP DRAWINGS AND ENGINEERING CALCULATIONS SIGNED AND SEALED BY AN ENGINEER LICENSED TO PRACTICE IN THE STATE OF TEXAS. THE DRAWINGS SHALL SHOW ALL WALL DESIGN FEATURES, INCLUDING BUT NOT LIMITED TO BACKFILL MATERIALS, GEOTEXTILE SIZE AND TYPE, DRAIN LINE SIZE AND CONFIGURATION, TIE BACK DEPTHS, STORM DRAIN OUTFALL CONNECTIONS, PROTECTION OF EXISTING FACILITIES AND INFRASTRUCTURE NOTED ON PLANS, ETC.

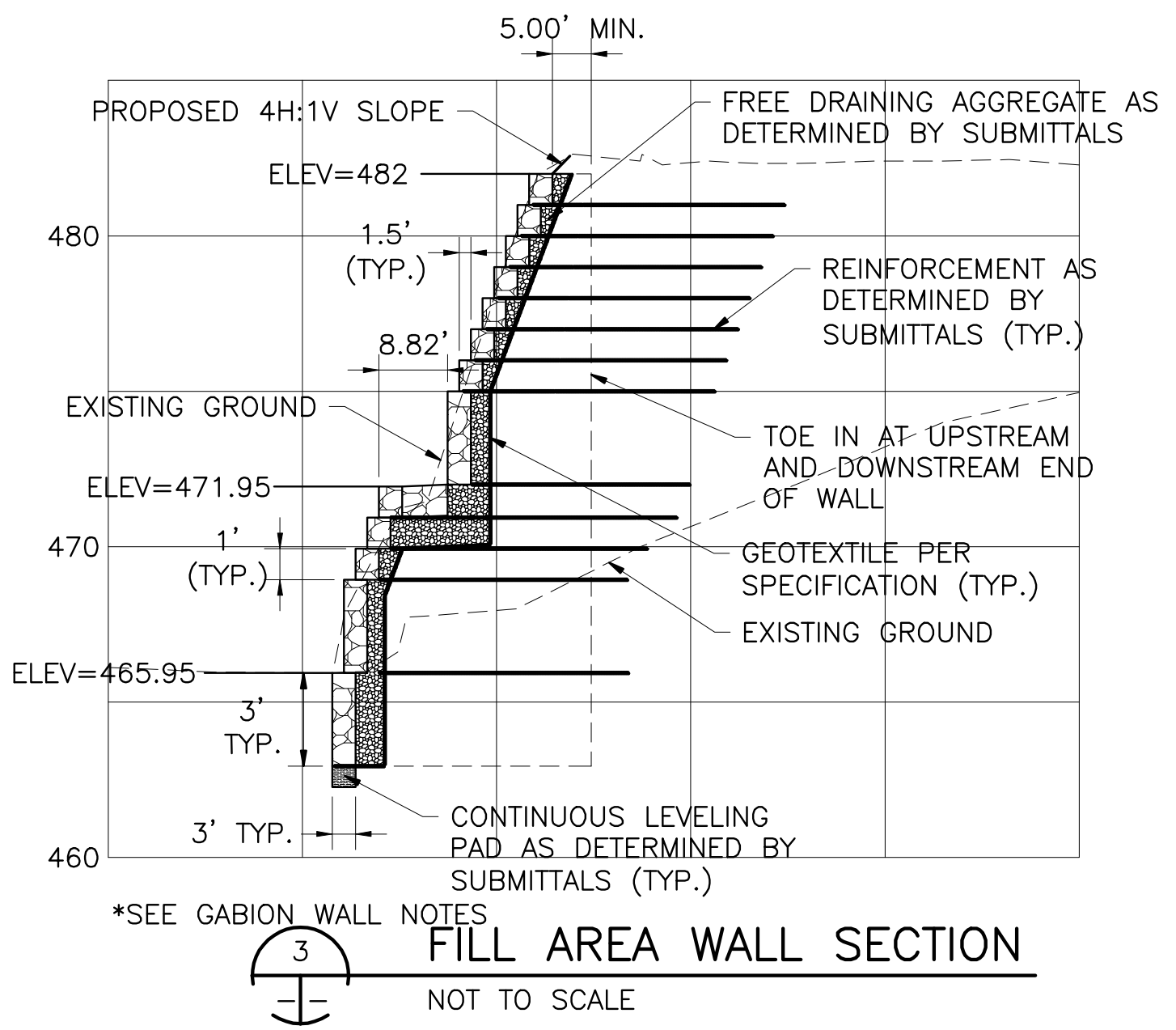

FILL AREA WALL SECTION
NOT TO SCALE

LEGEND
PROPOSED GABIONS
REFER TO DETAILS
SHEET 45 (PP-14)

NOTES:

- POND IS TO BE DREDGED AND DEWATERED BY METHOD SUBMITTED BY CONTRACTOR AND APPROVED BY THE OWNER. DREDGED MATERIAL SHALL BE DEWATERED ON-SITE IN LOCATION NOTED ON SHEET ER-1.
- POND TO BE GRADED AT 4H:1V PER GRADING SHOWN.
- DISTURBED AREAS ABOVE NORMAL POOL ELEVATIONS SHALL BE SODDED WITH BERMUDA GRASSES.
- CONTRACTOR TO PROVIDE 8 FT CHAIN LINK FENCE DURING CONSTRUCTION AROUND POND AND ADJACENT PARKING LOT AND 2-6\"/>

DUCK CREEK GREENBELT POND LAYOUT & GRADING PLAN



CITY OF GARLAND, TEXAS
UNIVERSITY CHANNEL IMPROVEMENTS
PUBLIC MEETING